

PLEASE READ AND UNDERSTAND!

these safety operations prior to using **The Electric Rug Gallery® Display System.**

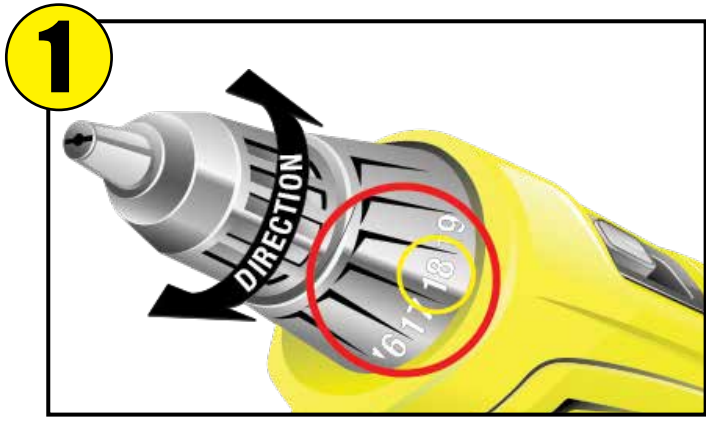

1 **ALWAYS** check direction & clutch setting of the cordless drill before inserting into lower gearbox!

Clockwise rotation will raise the display arm and counter-clockwise will lower. The cordless drill features a clutch setting from 1 to 21. **DO NOT** use the "drill" setting.

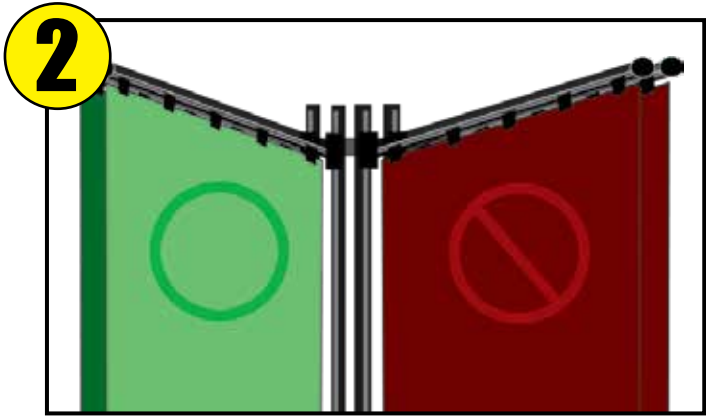

2 **ALWAYS** approach the carpet from the right!

To raise or lower the carpet; face the carpet from the right as the lower box is angled for better access for the drill attachment.

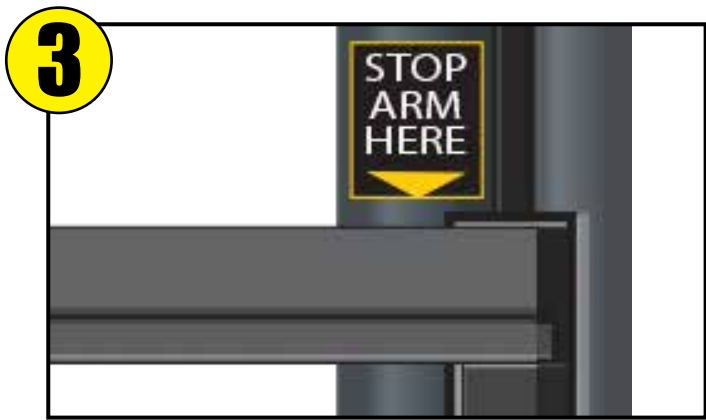

3 **ALWAYS** be aware of where the display arm is!

Stop the drill before the arm reaches the very top or bottom of travel. **DO NOT** raise or lower the arm past the STOP stickers. The arm is designed to be stopped anywhere and will stay in place.

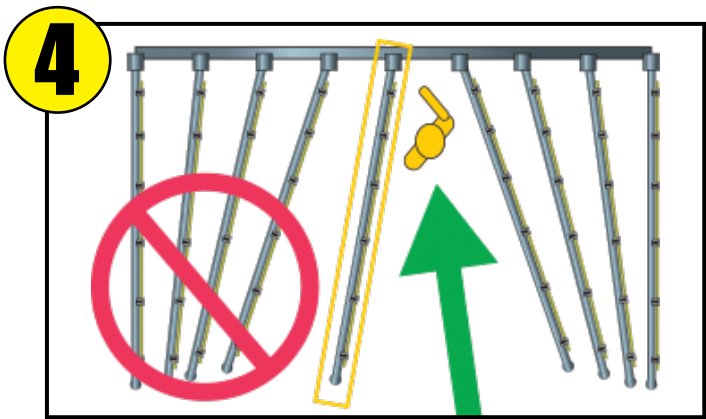

4 **ALWAYS** create a space for the arm to lower or raise!

Move arms away from either side to clear a path for the rug to be moved. Always ask your customers to stand back to allow the arm to travel in a safe manner.

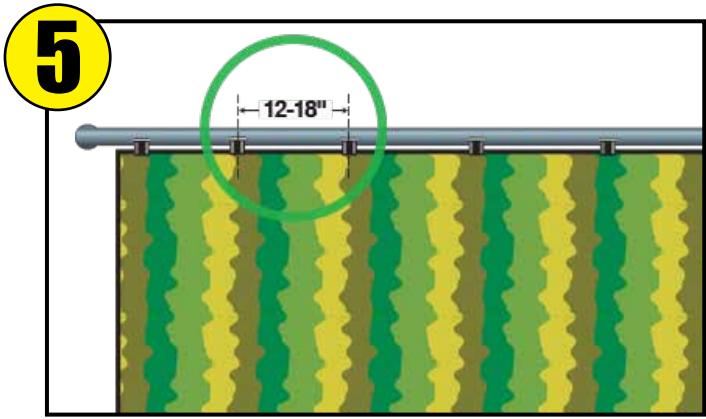

5 **ALWAYS** use the correct number of rug clips!

Starting at one end of the carpet; space your clips evenly at 12-18" intervals depending on the weight of the rug to be displayed. (Refer to proper clip usage in the supplied instruction manual)

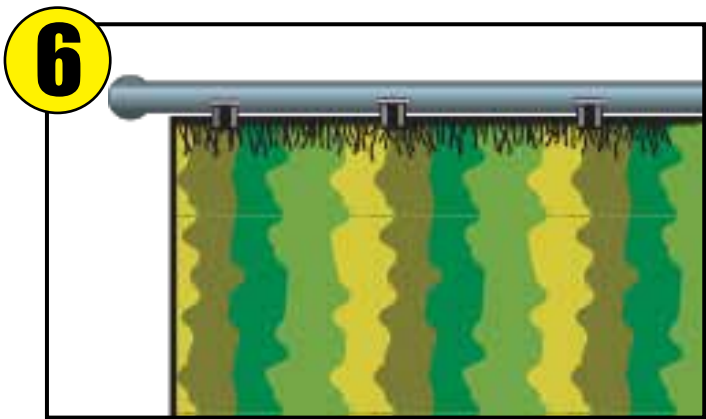

6 **ALWAYS** correctly hang the carpet by the weave!

Fold over the carpet fringes and attach the rug clip to the weave of the carpet. **NEVER** attach the clips to the fringes.

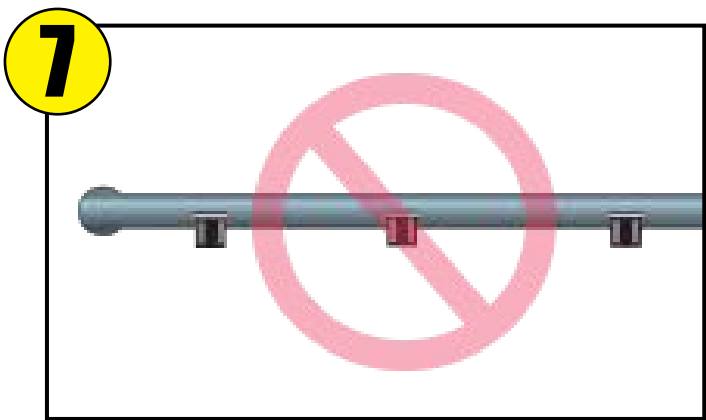

7 **NEVER** store rug clips on the empty carpet arm!

Without the rug's weight, the clips may get entangled with neighbouring display arms or carpets and cause the arm to jam.



Train all staff members who will use this rug gallery display system on the safe usage before allowing operation. Always follow recommended maintenance guidelines to keep equipment in proper working condition.

- Prior to hanging rugs, locate your new drill or drills and drill extension. Insert the drill extension into drill and tighten the drills keyless chuck as tight as possible. Try operating one arm before hanging a rug.
Before inserting drill into lower gearbox on arm, always check direction and clutch setting of drill first.
- Clockwise rotation will raise the display arm and counter clockwise will lower the display arm. When using the cordless drill, use any clutch setting over 15, but **DO NOT** set clutch to "Drill".
Never substitute our recommended drill a different model.
- Approach the carpet to be lowered or raised from the right. Since the lower box for the drill attachment is angled, it is easier to access from the right side
- When lowering an arm always create a space for the arm to come down in. Using the arm's length rule, move the arms on either side out of the way to clear a path. Make sure that the arm, clips or carpet is not accidentally hung up before operation. Damage to the arm's mechanism may occur if forced.
Always ask your customers to stand back to allow enough space to lower the arm in a safe manner.
- Always be aware of where the arm is. Do not raise or lower the display arm past the placed **STOP** stickers, although you can stop the arm anywhere between the stickers and the arm will stay in place. You may want to raise the arm up just until the rug fringe clears on shorter rugs rather than taking it to the top.
WARNING - DO NOT lower arm past the bottom STOP sticker. Doing so will damage the arm. To check any arms to see if this has happened by inserting the drill and slightly lowering each arm with the drill rotating counter clock wise. If any of the arms go up instead of down the cable has been wound in the wrong direction and the arm should not be used until repaired by our service department.
- Use the correct number of rug clips for the weight and size of the carpet to be displayed. Start on either side of the rug and evenly space the clips 12"-18" apart.
WARNING - DO NOT store unused rug clips on empty display arm.
They may get caught on neighbouring arms and carpets and cause an operation obstruction. They could also become dislodged and fall without warning, causing a danger to yourself and your customers.
- Correctly hang the carpet by the weave. Fold over the carpet fringes and attach the rug clip to the weave of the carpet. **NEVER attach the clips to the fringes.**
- This system is designed to operate indefinitely if the operating instructions have been followed. If for some reason one of your arms starts to operate differently please stop using the arm and contact Galt Display Rack Co. Ltd. and we will be glad to assist you.

GALT
DISPLAY RACK

**The Electric Rug Gallery Display®
Semi-Annual Maintenance Guide**

ITEM	INSPECTION AND CHECKLIST
1 Safety Brake	<ol style="list-style-type: none"> 1. Check condition of brake pad on each arm. Replace pad if ... <ol style="list-style-type: none"> 1.1 Torn 1.2 Separated from Wedge 1.3 Pieces of pad missing Contact Galt Display Rack Co. for replacement. Do Not Use Arm until Safety Brake components have been replaced! 2. Thoroughly clean all dust, lint or debris from pad. 3. Check condition of linkage, pins, end clips and engagement spring. 4. Replace any damaged or missing components. 5. Check linkage movements by slowly lifting arm and trolley assembly.
2 Cable	<ol style="list-style-type: none"> 1. Lower each arm to its lowest position. 2. Inspect the entire length of cable. Replace cable if ... <ol style="list-style-type: none"> 2.1 Kinked 2.2 Broken surface strands of wire 2.3 Open strands of cable Do Not Use Arm Until Cable Has Been Replaced!
3 Frame	<ol style="list-style-type: none"> 1. Check all assembly bolts to ensure they are tight. 2. Re-tighten any bolts found loose. 3. Check anchor bolts in floor and tighten any loose anchor bolts.
4 Trolley/Arms	<ol style="list-style-type: none"> 1. Inspect bolts and components on each trolley and arm assembly. 2. Check for loose bolts or missing components. 3. Tighten any bolts found loose and replace any missing components. 4. Refer to parts list and contact Galt Display.
5 Safety Collars	<ol style="list-style-type: none"> 1. Check locking collars are in place and set screws are tight. 2. Tighten loose set screws and replace any missing collars.

Failure to properly service and maintain your Electric Rug Gallery® on a regular basis will result in premature failure of the rack and/or component parts. Such failure could lead to injury to your employees or customers and/or damage to property.

SERVICE CONTRACTS are available for your Electric Rug Gallery®. For more information on these service contracts, please contact Galt Display Rack at 800-461-3892.



DO NOT stand under arms at any time!

GALT
DISPLAY RACK

for inquiries or assistance call
or scan the QR Code for more information

1.800.461.3892



SD-1-2023 EN ERG